



Kanca

TAZ / VOLZANIN / JCB



ŞAFT ASKI TAKIMLARI SHAFT CENTER SUPPORT BEARING

Araç / Vehicle	Ref. NR	Açıklama Description
JCB		Ø : 40 HC : 168.4 W : 27 H : 65



AB. 20990

KAMAZ		Ø : 65 W : 33
-------	--	---------------



AB. 20995

DIAPHRAGMS / DİYAFLAMLAR



Fig. 1



Fig. 2



Fig. 3



Fig. 4



Fig. 5

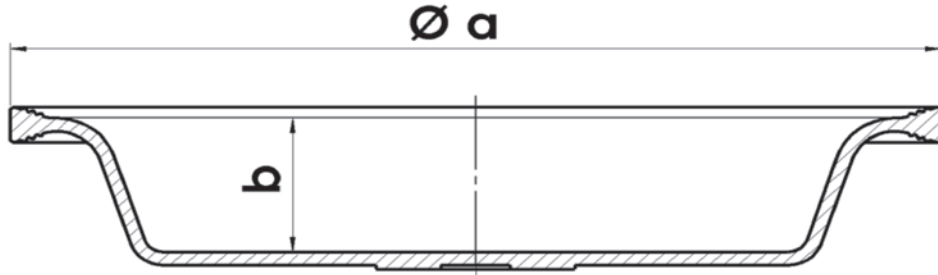

ÜRÜN KODU / PRODUCT CODE	ÜRÜN İSMİ / PRODUCT NAME	ŞEKİL / FIGURE	ÇAP / DIAMETER Ø a	DERİNLİK / DEPTH b
AA.10611	T.9 DİYAFLAM	Fig.1	129	25
AA.10610	T.12 DİYAFLAM	Fig.1	140	28
AA.10614	T.14 DİYAFLAM	Fig.1	145	30
AA.10608	T.16 DİYAFLAM	Fig.1	159	32
AA.10606	T.20 DİYAFLAM	Fig.1	168	32
AA.10604	T.24 DİYAFLAM	Fig.1	179	32
AA.10613	T.27 DİYAFLAM	Fig.1	201	34
AA.10603	T.30 DİYAFLAM	Fig.1	201	32
AA.10619	T.30 M DİYAFLAM	Fig.1	201	36
AA.10601	T.36 DİYAFLAM	Fig.1	224	42
AA.10617	T.9 LS DERİN DİYAFLAM	Fig.2	129	32
AA.10616	T.12 LS DERİN DİYAFLAM	Fig.2	140	34
AA.10612	T.14 LS DERİN DİYAFLAM	Fig.2	145	36
AA.10609	T.16 LS DERİN DİYAFLAM	Fig.2	159	44
AA.10607	T.20 LS DERİN DİYAFLAM	Fig.2	168	44
AA.10605	T.24 LS DERİN DİYAFLAM	Fig.2	179	44
AA.10615	T.27 LS DERİN DİYAFLAM	Fig.2	201	44
AA.10602	T.30 LS DERİN DİYAFLAM	Fig.2	201	44
AA.10620	T.36 LS DERİN DİYAFLAM	Fig.2	224	44
AA.10623	T.24 MEMELİ DİYAFLAM	Fig.3	179	32
AA.10622	T.30 MEMELİ DİYAFLAM	Fig.3	201	32
AA.10621	T.30 LS DERİN MEMELİ DİYAFLAM	Fig.3	201	47
AA.10624	T.12/16 DİYAFLAM	Fig.4	159	33
AA.10625	T.14/16 DİYAFLAM	Fig.4	159	33
AA.10627	T.16 S TİPİ DİYAFLAM	Fig.5	159	27
AA.10626	T.20 S TİPİ DİYAFLAM	Fig.5	170	25
AA.10628	T.24 S TİPİ DİYAFLAM	Fig.5	179	25



Araç / Vehicle	O.E.M. NR	Ref. NR	Type
TAZ		423 105 9000	20 STROKE 75 M16X1.5 Mil Boyu / Rod Length 186 mm
TAZ		423 106 9000	24 STROKE 75 M16X1.5 Mil Boyu / Rod Length 186 mm
VOLZANIN 5270		925 491 1410 925 491 1417	24/24 D/P STROKE 57/57 M22X1.5 Adaptor M16X1,5 Mil Boyu / Rod Length 250 mm



BS0020 10020



BS0024 10023



BP2424 10416