



Kanca

FORD



ŞAFT ASKI TAKIMLARI
SHAFT CENTER SUPPORT BEARING

Araç / Vehicle	Ref. NR	Açıklama Description
CARGO D-750, D-1210 / 1211		Ø : 40 RULMANSIZ WITHOUT BEARING

AL. 80114

CARGO 1312		Ø : 40 RULMANSIZ WITHOUT BEARING
---------------	--	--

AL. 80205

D-750, D-1210, D-1211	D47Z48000	Ø : 40 HC : 168,4 W : 18 H : 65
-----------------------	-----------	--

AB. 20302

CARGO 1312		Ø : 40 HC : 168,4 W : 18 H : 65
---------------	--	--

AB. 20304

D-750, D-1210, D-1211	B5TZ4840B	Ø : 40 HC : 168,4 W : 27 H : 65
-----------------------	-----------	--

AB. 20301

ŞAFT ASKI TAKIMLARI SHAFT CENTER SUPPORT BEARING



AB. 20303

Açıklama Description	Ref. NR	Araç / Vehicle
Ø : 40 HC : 168,4 W : 27 H : 65		CARGO 1312



AL. 80116

Ø : 45 RULMANSIZ WITHOUT BEARING		CARGO 1814 - 1214
--	--	----------------------



AB. 20306

Ø : 45 HC : 194 W : 19 H : 71,5		CARGO 1814 - 1214
------------------------------------	--	----------------------



AB. 20305

Ø : 45 HC : 194 W : 27 H : 71	D9H24800A	CARGO 1814 - 1214
----------------------------------	-----------	----------------------



AL. 80201

Ø : 55 RULMANSIZ WITHOUT BEARING		CARGO 2520
--	--	---------------

**ŞAFT ASKI TAKIMLARI
SHAFT CENTER SUPPORT BEARING**

Araç / Vehicle	Ref. NR	Açıklama Description	
CARGO 2520		Ø : 55	HC : 194
		W : 18	H : 76



AB. 20307

CARGO 3232 1832		Ø : 60	HC : 200
		W : 36	H : 82
		BORULU / WITH PIPE	



AB. 20310

CARGO 2524-2621-2626 3227-323		Ø : 60	HC : 220
		W : 22	H : 87



AB. 20308

CARGO 3235		Ø : 65	HC : 230
		W : 23	H : 85



AB. 20309

DIAPHRAGMS / DİYAFLAMLAR



Fig. 1



Fig. 2



Fig. 3



Fig. 4



Fig. 5

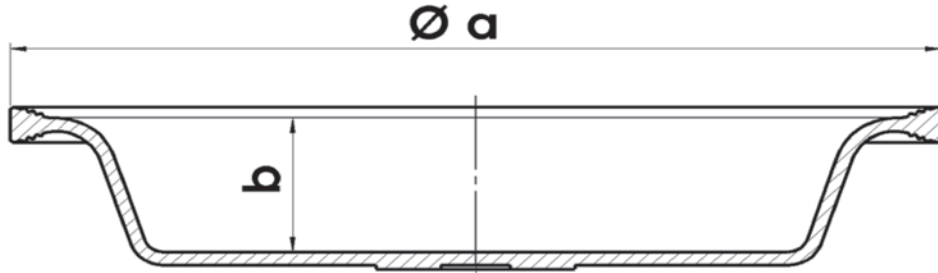

ÜRÜN KODU / PRODUCT CODE	ÜRÜN İSMİ / PRODUCT NAME	ŞEKİL / FIGURE	ÇAP / DIAMETER Ø a	DERİNLİK / DEPTH b
AA.10611	T.9 DİYAFLAM	Fig.1	129	25
AA.10610	T.12 DİYAFLAM	Fig.1	140	28
AA.10614	T.14 DİYAFLAM	Fig.1	145	30
AA.10608	T.16 DİYAFLAM	Fig.1	159	32
AA.10606	T.20 DİYAFLAM	Fig.1	168	32
AA.10604	T.24 DİYAFLAM	Fig.1	179	32
AA.10613	T.27 DİYAFLAM	Fig.1	201	34
AA.10603	T.30 DİYAFLAM	Fig.1	201	32
AA.10619	T.30 M DİYAFLAM	Fig.1	201	36
AA.10601	T.36 DİYAFLAM	Fig.1	224	42
AA.10617	T.9 LS DERİN DİYAFLAM	Fig.2	129	32
AA.10616	T.12 LS DERİN DİYAFLAM	Fig.2	140	34
AA.10612	T.14 LS DERİN DİYAFLAM	Fig.2	145	36
AA.10609	T.16 LS DERİN DİYAFLAM	Fig.2	159	44
AA.10607	T.20 LS DERİN DİYAFLAM	Fig.2	168	44
AA.10605	T.24 LS DERİN DİYAFLAM	Fig.2	179	44
AA.10615	T.27 LS DERİN DİYAFLAM	Fig.2	201	44
AA.10602	T.30 LS DERİN DİYAFLAM	Fig.2	201	44
AA.10620	T.36 LS DERİN DİYAFLAM	Fig.2	224	44
AA.10623	T.24 MEMELİ DİYAFLAM	Fig.3	179	32
AA.10622	T.30 MEMELİ DİYAFLAM	Fig.3	201	32
AA.10621	T.30 LS DERİN MEMELİ DİYAFLAM	Fig.3	201	47
AA.10624	T.12/16 DİYAFLAM	Fig.4	159	33
AA.10625	T.14/16 DİYAFLAM	Fig.4	159	33
AA.10627	T.16 S TİPİ DİYAFLAM	Fig.5	159	27
AA.10626	T.20 S TİPİ DİYAFLAM	Fig.5	170	25
AA.10628	T.24 S TİPİ DİYAFLAM	Fig.5	179	25

FOR OTHER TYPES OF BRAKE CHAMBER PLEASE CONTACT OUR COMPANY

Type	Ref. NR	O.E.M. NR	Araç / Vehicle
------	---------	-----------	----------------



BS0020 20009

20	423 505 0000		
STROKE 62			
M16X1.5			
Disk Boyu / Disc Lenght 15 mm			



BS0024 20020

24	423 506 0010		
STROKE 65			
M16X1.5			
Disk Boyu / Disc Lenght 15 mm			



BS0012 10003

12	423 103 9000		
STROKE 57			
M16X1.5			
Mil Boyu / Rod Lenght 186 mm			



BS0020 10015

20	423 105 1110		
STROKE 57			
M16X1.5			
Mil Boyu / Rod Lenght 20 mm			

FOR OTHER TYPES OF BRAKE CHAMBER PLEASE CONTACT OUR COMPANY

Araç / Vehicle	O.E.M. NR	Ref. NR	Type
		423 105 9000	<p>20 STROKE 75 M16X1.5 Mil Boyu / Rod Length 186 mm</p>
		423 106 9000	<p>24 STROKE 75 M16X1.5 Mil Boyu / Rod Length 186 mm</p>
		423 107 9000	<p>30 STROKE 75 M16X1.5 Mil Boyu / Rod Length 186 mm</p>
		423 142 0010	<p>9 STROKE 44.5 M16X1.5 Boru Boyu / Tube Length 138 mm</p>



BS0020 10020



BS0024 10023



BS0030 10037



BS0009 30001

FOR OTHER TYPES OF BRAKE CHAMBER PLEASE CONTACT OUR COMPANY

Type	Ref. NR	O.E.M. NR	Araç / Vehicle
------	---------	-----------	----------------



BS0012 30003

12
STROKE
44.5

M16X1.5

Boru Boyu / Tube Length
148 mm

93CT2025EB



BS0012 30004

12
STROKE
44.5

M16X1.5

Boru Boyu / Tube Length
163 mm

93CT2025FA



BP1624 20420

16/24
D/P
STROKE
57/57

M16X1.5

Disk Boyu / Disc Length
15 mm

925 464 5000



BP1624 20421

16/24
D/P
STROKE
57/57

M16X1.5

Disk Boyu / Disc Length
15 mm

925 464 5017
925 464 5050
925 464 5010

FOR OTHER TYPES OF BRAKE CHAMBER PLEASE CONTACT OUR COMPANY

Araç / Vehicle	O.E.M. NR	Ref. NR	Type
	91CT2025EA		9/6200 D/P STROKE 44.5/44.5 M16X1.5 Boru Boyu / Tube Length 187 mm
CARGO			9/6200 D/P STROKE 44.5/44.5 M16X1.5 Boru Boyu / Tube Length 225 mm
	95CT2025BA		9/7400 D/P STROKE 44.5/44.5 M16X1.5 Boru Boyu / Tube Length 187 mm
	93CT2025OA		12/6200 D/P STROKE 44.5/44.5 M16X1.5 Boru Boyu / Tube Length 187 mm

BP9620 30401

BP9620 30404

BP9740 30405

BP1262 30407
FOR OTHER TYPES OF BRAKE CHAMBER PLEASE CONTACT OUR COMPANY

Type	Ref. NR	O.E.M. NR	Araç / Vehicle
------	---------	-----------	----------------



BP1262 30408

12/6200

D/P

STROKE
44.5/44.5
M16X1.5

Boru Boyu / Tube Length
187 mm

CARGO



BP1262 30409

12/6200

D/P

STROKE
53/53
M16X1.5

Boru Boyu / Tube Length
187 mm

423 327 0640

CARGO



BP1262 30423

12/6200

D/P

STROKE
44.5/44.5
M16X1.5

Boru Boyu / Tube Length
168 mm

3C462025BA



BP1262 30424

12/6200

D/P

STROKE
44.5/44.5
M16X1.5

Boru Boyu / Tube Length
193 mm

93CT2025DB

FOR OTHER TYPES OF BRAKE CHAMBER PLEASE CONTACT OUR COMPANY

Araç / Vehicle	O.E.M. NR	Ref. NR	Type
	VXCT2025AA		12/6200 D/P STROKE 44.5/44.5 M16X1.5 Boru Boyu / Tube Length 250 mm
	6C462025EA		12/6200 D/P STROKE 44.5/44.5 M16X1.5 Boru Boyu / Tube Length 250 mm
	6C462025FA		12/6200 D/P STROKE 44.5/44.5 M16X1.5 Boru Boyu / Tube Length 193 mm
	6C462025DA		12/6200 D/P STROKE 44.5/44.5 M16X1.5 Boru Boyu / Tube Length 168 mm

BP1262 30425

BP1262 30426

BP1262 30427

BP1262 30428

FOR OTHER TYPES OF BRAKE CHAMBER PLEASE CONTACT OUR COMPANY